

# Exmoor Street

## SOUTHVILLE

APPROXIMATE FLOOR AREA  
92.1 SQM / 991 SQFT



GROUND FLOOR  
386 sq.ft. (35.9 sq.m.) approx.

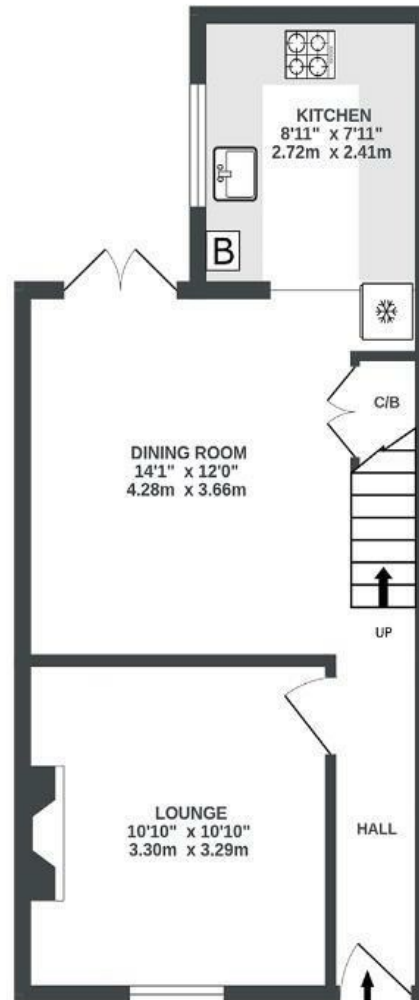

1ST FLOOR  
386 sq.ft. (35.9 sq.m.) approx.

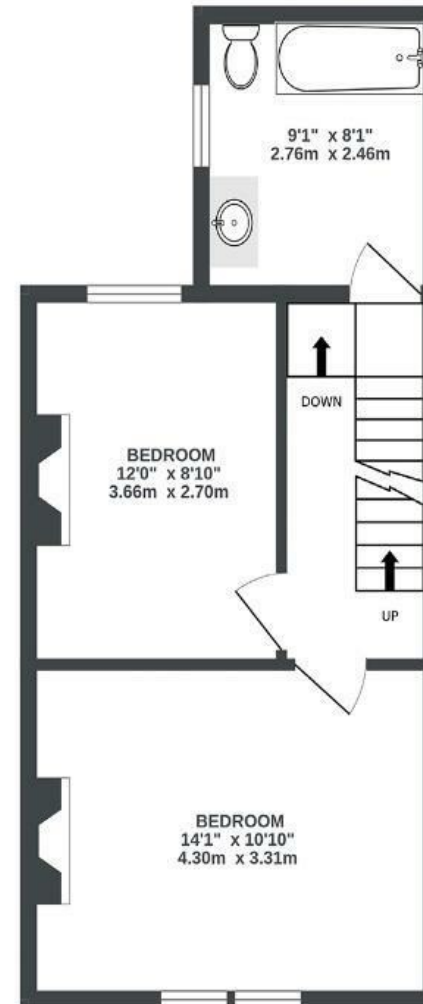

2ND FLOOR  
219 sq.ft. (20.3 sq.m.) approx.

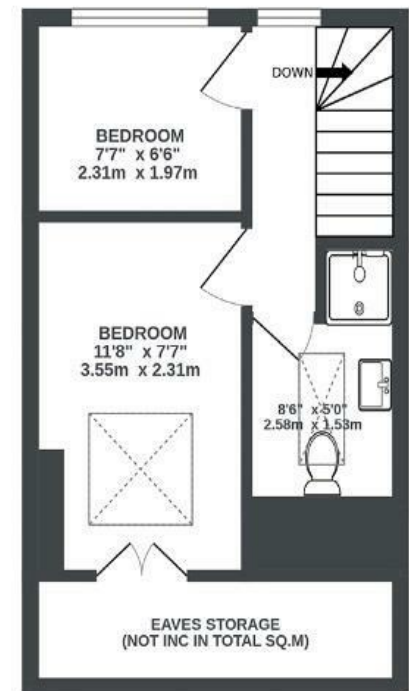

Boardwalk

# Exmoor Street , BRISTOL

£

£475,000



BS3 1HD

zzz

4 Bedrooms



2 Bathrooms

*"We couldn't have asked for a better place to live than on Exmoor Street. We have been surrounded by wonderful neighbours and local businesses. Great restaurants and coffee shops are right on our door step. Our house has felt cosy and welcoming and we will miss being surrounded by a great community."*

